

The background of the entire page is a photograph of a winter landscape. It shows a snow-covered path leading towards a body of water, likely a lake or a wide river. The trees are bare and covered in a thick layer of snow. A wooden bench is visible on the path, partially covered in snow. The sky is a pale, overcast blue. The overall scene is serene and quiet.

JANUARY EDITION
GKC CONNECT
Association News
at a Glance

WELCOME TO OUR GKC MGMA 2023 Board Officers



THE GKC MGMA PUZZLE ISN'T
COMPLETE WITHOUT YOU!
YOU MATTER!



BOARD OFFICERS

- PRESIDENT** BARBARA SACK, FACMPE MSHA *(Succession)*
PRESIDENT ELECT REBECCA ALLISON, MBA *(Succession)*
PAST PRESIDENT ANDREA WYATT, FACMPE MBA *(Succession)*
TREASURER BRAD CARNEY, FACMPE CPC CPCO *(1 year term-Elected)*
SECRETARY JASON STALLING, MBA CFHA *(1 year term-Elected)*

MANAGER MEMBERS AT LARGE COMMITTEE CHAIRS *1-year terms (Elected)*

- Programs** BARBARA BERGMAN, MBA CMPE
Membership ASHLEY BLACKETER
Social Media CO-CHAIRS TEMPERANCE MCFARLAND &
CAROLYN BARUCH

BUSINESS PARTNER AT LARGE *2-year term (Appointed)*

- BP Member at Large** LOU ANNE GONZALES *(2nd of 2 years)*
BP Member at Large SCOTT WALTERBACH, JD *(2nd of 2 years)*
ACMPE Forum Tracy Bird – FACMPE AAPC CPC CPMA CEMC CPC-I



BECOME A PRECEPTOR for KCU



Contact Us To Learn More!

VALORIE MILLICAN

Senior Director of Clinical Education
vmillican@kansascity.edu
816-654-7332

KCU DEPARTMENT OF CLINICAL EDUCATION

clinicaleducation@kansascity.edu
816-654-7330

Make a Positive Impact on the Next Generation of Physicians

Become a Preceptor for KCU

- Kansas City University has collaborated with hospitals, physicians and health systems like yours for decades. Our Department of Clinical Education provides the resources and tools to make the preceptor experience successful for everyone involved. Your investment of time and expertise will be rewarded by the patient-care our students provide, under your quality supervision and direction.

Benefits of Training Medical Students

- KCU College of Osteopathic Medicine is proud to partner with hospitals and physicians across the country to provide advanced clinical training to third and fourth-year medical students. Through this experience, our medical students receive invaluable hands on experience, and partner hospitals and physicians receive valuable benefits.

Preceptor Benefits

- **Exceptional student doctors to assist you in your day-to-day practice**
- **Continuing medical education credits (CME)**
- **Appointment as Adjunct Instructor with the opportunity to apply for Adjunct Faculty**
- **Financial compensation (when applicable)**
- **New Missouri Preceptor Tax Credit Incentive (SB 801):**

For all tax years on or after January 1, 2023, this act authorizes a taxpayer to claim a tax credit for serving as a community-based preceptor for a medical student's core preceptorship as such terms are defined in the act. The tax credit shall be equal to \$1,000 for each preceptorship, but not to exceed \$3,000 in any tax year. Tax credit authorized by the act shall not be refundable or transferable, and shall not be carried forward or backward to any other tax year. The total amount of tax credits authorized in a given year shall not exceed \$200,000. Additional tax credits may be authorized provided in amount not to exceed the excess funds available in the Medical Preceptor Fund, as created by the act.

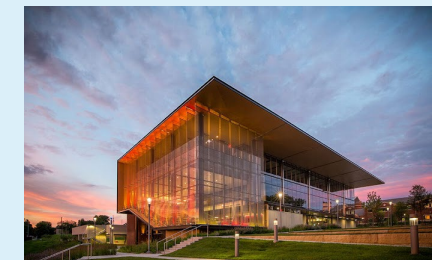

Fun with substance!

Guest speaker Dr. Bowen White, MD provided invaluable thoughts to consider incorporating into our lives at GKC's December meeting. Exceptional presentation.

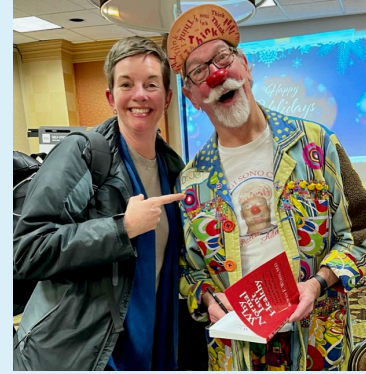
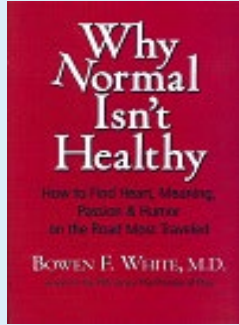

Dr. White signs his books for attendees at end of meeting (Jennifer popped in photo with him). Lots of laughter and smiles!



Thanks to Cinda Dowell of ScanSTAT (c.) for manning the registering table and offered two door prizes. Barbara Sack (l.) and Andrea Wyatt (r.) were the lucky winners. Incoming president Barbara Sack also presented a gift to Andrea for her service this past year.



MASTER YOUR WEEK IN 3 MINUTES OR LESS.

What Mantras Will Help You Make Better Choices In 2023?



Insights From The Jones Zone

Click the link below for this week's video:

<https://www.youtube.com/watch?v=D95fjTlw7HQ>

JONES LOFLIN

HELPING YOU MAKE THE BEST CHOICES WITH YOUR TIME SO YOU CAN THRIVE!



May you have a week where your mantras keep you connected to what's most important.

Mantra

An affirmation to keep you connected to a particular state of mind.



To help me stay focused I like to use mantras. Here are three at the top of my list for 2023.

For More On Today's Topic:

If your mantra is "I want to NOT work all the time"

If your mantra is "I want to be more proactive with change"

If your mantra is, "I delegate so I don't have all the pressure on me"

January 19, 2023
Meeting Speaker
Still Time to Register!



"Why Do I Do Paperwork?"

Speaker: Scott Walterbach, JD

Answer: Because paperwork is critical on the back end of the revenue cycle. And without a back end, it's not a cycle.

Learning Points:

- Whether you outsource bad debt or not, this presentation is for you.
- When you know how courts work on the back end, you can adjust what you do on the front end.
- And that makes you more intentional, purposeful & robust.
- And that should give you confidence in an uncertain world.

Registration Link Open:

<https://gkcmgma.org/event-4870916>

Location:

Holiday Inn & Suites Overland Park West

8787 Reeder Street, Overland Park KS

Time: 3:00pm – 5:00pm

Registration, food, networking, and presentation

Close no later than 5:30pm



Social Media Committee News

Co-Chairs Carolyn Baruch and Temperance McFarland, and the entire Social Media Committee are looking forward to tackling big goals in 2023!

The committee will have their first meeting on February 8th, although planning is well underway. The Social Media Committee intends to work closely with the Membership Committee to help improve GKC MGMA's presence virtually and push for an increase in member enrollment in 2023.

The group is also looking to hear from YOU. If you have ideas or are interested in a spotlight on the pages, please reach out to Temperance at tmcfarland@kcpsych.com. Additionally, please follow, like, SHARE, COMMENT, and connect with us on Facebook (<https://www.facebook.com/gkcmgma.nfp>) and LinkedIn (www.linkedin.com/in/gkc-mgma)!

2023 MONTHLY MEETING PROGRAMS

What the Program Committee has secured for 2023



January 18 at HI&S OPW (confirmed)
Speaker: Scott Walterbach, JD
Topic: "Why Do I Do Paperwork?"



February 15 at Chappell's R&SM (confirmed)
Speaker: Tracy Bird
Topic: "Benchmarking for Practice Success"



March 15 at HI&S OPW (confirmed)
Speaker: Dr. David Farrar (confirmed)
Topic: "Mentoring for the Health of Your Workplace"



April 19 at Chappell's (confirmed)
Speaker: Kyle Adkins COO
Topic: "Creating Personal & Team Accountability"



May 17 at HI&S OPW (confirmed)
Speaker: Kylie Livingston
Topic: "Leadership Development"



June 21 at Chappell's R&SM (confirmed)
Speaker: Dee Nolting
Topic: "Engaging for Success: Maximizing Your Team Potential"



July 19 at HI&S OPW
Speaker:
Topic:

August 16 at Chappell's R&SM
Speaker:
Topic:

September 20 at HI&S OPW (confirmed)
Speaker: David Smith
Topic: "No Surprises Act – Updated"

October 18 at Chappell's (or conference)
Speaker:
Topic:

November 15 at HI&S OPW
Speaker:
Topics:

December 20 at HI&S OPW
Speaker: Annual Business Meeting with a guest speaker (TBD)
Topic:

MONTHLY MEETING LOCATIONS

SOUTH: *Holiday Inn & Suites OPW, Reeder Street, OP, KS*

NORTH: *Chappell's Restaurant & Sports Museum*

2023 GKC Year's Theme

"You Matter!"

THE PUZZLE ISN'T COMPLETE
WITHOUT YOU!



Simply being a member of GKC MGMA is a contribution to the association. Each and every member matters. And collectively it creates a vibrant community that can move mountains.

**THE CONTRIBUTION YOU OFFER
MATTERS. THANKS!**

SOCIAL MEDIA COMMITTEE

GET INVOLVED IN SOCIAL MEDIA IN 2023



If you aren't a member of GKC MGMA, please consider joining us in 2023 on LinkedIn. Let's all get connected! Over 524 have!

The Social Media Committee asks for your help in 2023 to connect with GKC LinkedIn, and then Like, Comment and Share each others' posts. Use our hashtags: **#GKC #GKCMGMA**



If you have any ideas related to social media or want to help keep the ball rolling, send your ideas to Carolyn Baruch at info@highlandgroup.net

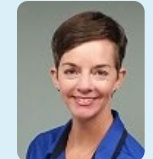

What would be the value to you of a holiday season with less stress and more meaning? I believe that one of the keys to making this a reality is to create a "No List."



Click the link below the image at right to view the video.

Why "NO" Is The Best Gift You Will Give Yourself This Season



 *Insights From The Jones Zone*

<https://www.youtube.com/watch?v=20xSn7USuo8>

For More On Today's Topic
The 7 Best Ways To Avoid Overload
During The Holidays

May you have a week where you create a "No List" that helps you say YES to a better holiday season.

Jones

PS: Why not [sign up to receive my weekly insight](#)

Copyright © 2022 Jones Loflin, All rights reserved.

You are receiving this email because you signed up to receive a weekly communication from Jones Loflin.

Our mailing address is:

Jones Loflin

80 Farmbrook Drive

Denton, NC 27239

[Add us to your address book](#)

Want to change how you receive these emails?

You can [update your preferences](#) or [unsubscribe from this list](#)

MEMBERSHIP COMMITTEE FOR 2023



Ashley Blacketer,
Chair



Chris
Campbell

Interested in
Joining this
Committee?

Email Ashley at
[ablacketer@imaging4
women.com](mailto:ablacketer@imaging4women.com)

2023 New Members

1. Amy Yang, **student**

University of Kansas Medical Center

Welcome

2022 New Member List

+ 3 student doctors from KCU

Peggy Driver, Hunkeler Eye Institute

Jennifer Luttrell, Mid-America Gastro-Intestinal Con.

Sheneka High, Baby and Child Association

Mike Mendez, AccurIT Systems/HealthIT

Joel Feder, DO, KC University, College Osteopathic
Med.

Theryn Johnson, Facial Surgery Group

Dr. James A Di Renna, Barnes Medical Group

Chelsea Stuart, Orthopedic Surgeons, Inc,

Branden Chavez, Orthopedic Surgeons Inc.

Jolie Diaz, Jeff David Insurance

Nathan Roberts, Clemons Real Estate

Temperance McFarland, KC Psychiatric Group

Justine Dickey, ScanSTAT

Nancy Stuchlik, Medical Provider Resources

Marty Gilchrist, Cushman & Wakefield

Wendy Behr, Women's Health Associates

Christine Parsons, Schooley Mitchell

Samantha Palmieri, Blue KC

Myranda Cleary, Blue KC

David Johnson, Cradle Thru College Care

Tamy Brown, MA Heart & Lung Surgeons

Chuck Lyon, Central States Recovery

Steve Cargill, e Sentire

Amy Burke, AB Marketing Company

Brenda Olson, Great Plains Health Alliance



new
members

OPEN JOB DESCRIPTIONS

Submitted by Warren Retina Associations
on 01-04-2023

Clinical Assistant

Warren Retina Associates, an ophthalmology practice, is seeking a clinical assistant to assist our provider with patient work up, exams, procedures and tests. Our office is located in Overland Park. The position is full time Mondays – Fridays with insurance and dental benefits. It requires a person who possesses compassion, who is organized and attentive to details, and who is a quick study. Some experience in working in a clinic is valuable. Pay is negotiable with experience.

Please give our office a call at 913-339-6970 and ask for Carolyn.

P/T Position

Warren Retina Associates has a part-time position available to assist patients with administrative tasks such as appointments, insurances, and coordinate referrals from other physicians/hospitals. Approximately 24-32 hours a week, Mondays – Thursdays between the hours of 8-5pm. Hours and times are negotiable. High priority in possessing skills such as attention to detail and organization. Must have some experience in health insurance and working in a health facility.

Please call Carolyn at 913-339-6970 for more details.

THE PUZZLE ISN'T
COMPLETE WITHOUT YOU!



YOU MATTER!

Upcoming 2023 GKC Scheduled Meetings

 **Monthly
Education
Meeting**

 **Board
Meeting**

 **Annual
Conference**
To Be Determined

January

su	mo	tu	we	th	fr	sa
	1	2	3	4	5	6
7	8	9	10	11	12	13
14	15	16	17	18	19	20
21	22	23	24	25	26	27
28	29	30	31			

February

su	mo	tu	we	th	fr	sa
		1	2	3	4	
5	6	7	8	9	10	11
12	13	14	15	16	17	18
19	20	21	22	23	24	25
26	27	28				

March

su	mo	tu	we	th	fr	sa
		1	2	3	4	
5	6	7	8	9	10	11
12	13	14	15	16	17	18
19	20	21	22	23	24	25
26	27	28	29	30	31	

April

su	mo	tu	we	th	fr	sa
						1
2	3	4	5	6	7	8
9	10	11	12	13	14	15
16	17	18	19	20	21	22
23	24	25	26	27	28	29
30						

May

su	mo	tu	we	th	fr	sa
	1	2	3	4	5	6
7	8	9	10	11	12	13
14	15	16	17	18	19	20
21	22	23	24	25	26	27
28	29	30	31			

June

su	mo	tu	we	th	fr	sa
				1	2	3
4	5	6	7	8	9	10
11	12	13	14	15	16	17
18	19	20	21	22	23	24
25	26	27	28	29	30	

July

su	mo	tu	we	th	fr	sa
						1
2	3	4	5	6	7	8
9	10	11	12	13	14	15
16	17	18	19	20	21	22
23	24	25	26	27	28	29
30	31					

August

su	mo	tu	we	th	fr	sa
						1
2	3	4	5	6	7	8
9	10	11	12	13	14	15
16	17	18	19	20	21	22
23	24	25	26	27	28	29
30	31					

September

su	mo	tu	we	th	fr	sa
					1	2
3	4	5	6	7	8	9
10	11	12	13	14	15	16
17	18	19	20	21	22	23
24	25	26	27	28	29	30

October

su	mo	tu	we	th	fr	sa
	1	2	3	4	5	6
7	8	9	10	11	12	13
14	15	16	17	18	19	20
21	22	23	24	25	26	27
28	29	30	31			

November

su	mo	tu	we	th	fr	sa
						1
2	3	4	5	6	7	8
9	10	11	12	13	14	15
16	17	18	19	20	21	22
23	24	25	26	27	28	29
30	31					

December

su	mo	tu	we	th	fr	sa
						1
2	3	4	5	6	7	8
9	10	11	12	13	14	15
16	17	18	19	20	21	22
23	24	25	26	27	28	29
30	31					



2 Open Positions

Title: Certified Professional Coder

Title: Lead Certified Professional Coder

Location: Remote with occasional hybrid requirements in office.
Address: 2861 NE Independence Ave, Suite 201, Lee's Summit MO 64064.

Job Description:

Sano Orthopedics is in search of a Certified Professional Coder to join our innovative practice. This Group provides care within their clinics along with performing surgeries and consultations at local facilities. Looking for a detail-oriented person, with knowledge in Orthopedics and Spine, preferably with a background in surgery coding. Coder would be responsible for performing a quality review of the medical documentation, assign codes specific for the type of care provided and data entry into the practice's billing system. In-house system training is provided. However, looking for someone who is ready to jump in with both feet from day one.

Sano was founded to offer an innovative and unique approach to musculoskeletal care through an unmatched level of service, quality, and expertise to improve the lives of our patients and community.

Responsibilities:

- Assign and sequence all codes for services rendered on billable and non-billable encounters based on the accepted coding practices, guidelines, and policies.
- Collaborate with billing department to ensure all bills are satisfied in a timely manner.
- Submit statistical data for analysis and research to other departments.
- Communicate with physicians and other health care professionals regarding edits, queries and correct billing needs.
- Assist in improving processes and work flow within the Revenue Cycle.

To review the differences in the two open positions please visit:

<https://gkcmgma.wildapricot.org/jobs/>

Qualifications:

- Certified Professional Coder (CPC).
- Prefer a minimum of 5 years medical coding experience.
- Clinic and Surgical coding in Orthopedics is **highly** desirable.
- Ability to work independently in a fast-paced environment.

Job Type: Full-time

Benefits: 401(k), 401(k) matching, Dental insurance, Disability insurance, Health insurance, Paid time off, and Vision insurance.

Schedule: 8 hour shift. Monday to Friday

Experience:

- CPC Certified: 2 years (Preferred)
- Coding: 2 years (Preferred)

License/Certification:

- Certified Professional Coder certificate (Required)

Work Location:

- Hybrid remote in Lees Summit, MO 64064

Please send resumes to: kkincaid@sanoorthopedics.com



**ASSOCIATION
STATEMENTS**

OUR VISION

Our Vision is to be the recognized source for development and collaboration of healthcare leaders.

OUR MISSION

The Mission of Greater Kansas City MGMA is to enhance healthcare leadership through education, collaboration and networking.

OUR VALUES

- Integrity**
- Collegiality**
- Engagement**
- Respect**



Cybersecurity Tip

Take a Zero Trust approach to all incoming emails. Even email that *appears* to come from a known sender could be a phishing attempt.

Cybercriminals strike when you least expect them.

FBI Director Robert Mueller once said, "There are only two types of companies: those that have been hacked, and those that will be."

Ransomware. Viruses. Trojans. These are the bad actors lurking in cyberspace, waiting to pounce on unsuspecting businesses with weak security. They aim to steal your precious data because cybercrime is big business. It's a trillion-dollar "industry" that hurts thousands of SMBs each year. Don't let your business fall prey.

Umbrella protects your company by keeping your security up to date with the latest solutions, future-proofing your business from emerging cyberthreats. We increase your security, reduce your risk, and provide training for the weakest link in your security chain: IT end users, a.k.a. your staff. Don't fall victim to malicious online criminals. Protect your business with Umbrella's Cybersecurity solutions.

Contact us today to learn more!

umbrella.ms.com | 505 Walnut Street Kansas City, MO | 816-437-7265



SCAN ME

ADVERTISE IN 2023!

No Cost to Business Partners

**Make Our Puzzle Complete!
Choose An Option!**

1. SPONSOR A WEBSITE PAGE:

All we need is your company logo or a small ad that you create. We'll post it on an available page. Only 1 ad per page.

2. SPONSOR AN AD FOR NEWS ISSUES:

Either monthly, quarterly, or annually. Send us your logo or ad and we'll post.

*3. SPONSOR A MEETING OR SPEAKER FEE:

GKC will place your logo and ad on the event webpage, in all advertising, etc. - 1 sponsor per monthly event.

All partners interested in providing a presentation or placing an advertisement in our news issue, sponsor a monthly meeting, or create a video agree to abide by the terms of our bylaws. Send your idea or call the office if you have interest in any of these options.

Have another idea? We're listening!!!

**THE PUZZLE ISN'T COMPLETE WITHOUT YOU!
YOUR CONTRIBUTION MATTERS!**



4. MONTHLY OR ONE TIME OPTION

Create a short educational videos 1-3 min clip, an advertisement, or logo in monthly newsletter or on the website partner page. Choose a month.

5. HAVE AN IDEA?

Submit it to the board. Email your idea and it will be reviewed at the next board meeting for consideration.

Contact the GKC Central Office with your request:
info@gkcmgma.org

EFC

Executive Financial Consultants



Chris Robbins, Manager

P.O. Box 34497
North Kansas City, MO 64116
816-221-1333
crobbsins@efc-collect.com

Early Out -

EFC can customize a pre-collection program to assist you in communicating with patients after date of service and before outside collections begins to reduce the workload on your staff. Depending on your specific offices' needs, we can develop a program of calls, notices and electronic communications.

Emails/Standard Notices -

We will utilize the patient's email that was provided to you at intake as well as the standard U.S. Postal Service to make contact with your patients who are past -due. Furthermore, EFC will attempt to make contact with patients through all available and permitted electronic methods.

Litigation -

With the Credit Bureaus' announced changes to its treatment of Medical Debt coming in March 2023, litigation of past-due accounts may become a very important tool for your accounts receivable department. EFC will develop a process for litigation of those qualifying accounts.

Texting Campaigns -

EFC has developed an Extensive Texting campaign to reach out to patients. This enables your patients to self-cure their accounts at their finger-tips. From detailing a dispute to paying the account off, the consumer can resolve the account twenty-four (24) hours a day.

Scrubbing and Scoring Accounts -

When you place an account with EFC, we will run that account through several data bases to scrub for: Bankruptcies, Address Changes, Deceased Index to name a few. We will also run the accounts through Scoring models to assist in determining potential financial status and the actions needed to resolve the accounts.



FORUM NEWS

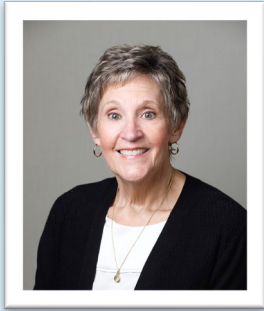

Tracy Bird

FACMPE, CPC, CPMA,
CEMC, CPC-I
GKC ACMPE Forum Rep.



**CONTINUING
EDUCATION**

ACMPE Board Certification Requirements



Continuing education – 50 hours

- **30 hours** – MGMA National, State, Local
 - Webinars
 - Article Assessments
 - Lunch and Learns
- **12 of the 30 hours** – LIVE Learning from MGMA National, State, or local
 - Live webinars
 - Face-to-face events
- **20 hours** – Qualified sources that pertain to the medical practice management field or MGMA
 - Recognized professional associations/organizations
 - College coursework
 - Formal presentations
 - Distance learning with interactivity

There are now 3 Pathways to Certification.

At right, see the page that shows the 3 pathways. Look at Start your CMPE pathway.

Any of the 3 pathways is acceptable.

On the next 2 pages is a clipping of slides from my National Presentation and the continuing education requirements.

Hope to see you in a future session. If I can be of help, please don't hesitate to contract me. -- Tracy



Which Pathway to Certification Do I Qualify For?

PATHWAY 1

- Active MGMA Member
- Purchase and complete application
- 2 years of healthcare experience
- Bachelor's degree or 120 college credit hours

PATHWAY 2

- Active MGMA Member
- Purchase and complete application
- May complete the program once both experience and education are met (2 years of healthcare experience with a Bachelor's degree or 120 college credit hours)

PATHWAY 3

- Active MGMA Member
- Purchase and complete application
- 6 years of healthcare experience
- Of the 6 years, at least 4 years must be in a healthcare management or leadership role

ACMPE BOARD CERTIFICATION

FREE eWorkbook
with Application

Apply today and receive a
FREE ACMPE Exam eWorkbook — a \$119 value!

Apply at mgma.com/state-cert

Program Criteria

EXAM REQUIREMENTS

After receiving program acceptance, applicants must register for and complete a multiple-choice exam and scenario-based exam. Those in pathway two may not take the scenario-based exam until their education and experience requirements are met. Exams are purchasable on the MGMA website and offered on an on-demand basis through live-remote-proctoring (LRP) and at testing facilities throughout the country.

ACMPE BOARD ELIGIBLE CLASSIFICATION

The ACMPE Board Eligible classification allows candidates to enter the Board Certification program through pathway two even though they may not yet meet the requirements of the Bachelor's degree or two years of healthcare experience.

To achieve Board Eligibility, candidates must show an understanding and knowledge of the principles of medical practice administration by passing the multiple-choice exam. Board Certification will be achieved when candidates attain their bachelor's degree, two years of healthcare experience, complete the required continuing education credit hours and pass the scenario-based exam.

CONTINUING EDUCATION REQUIREMENTS

Candidates are required to earn 50 hours of continuing education credit. Of the 50 hours, 30 must be from MGMA National, state or local. Of the 30 hours, 12 must be LIVE learning from MGMA National, state or local. The remaining 20 hours may come from either MGMA or qualified outside sources starting once their application is accepted, backlogging up to three years prior to their application purchase date.

CERTIFICATION DEADLINE

Candidates who apply for Board Certification are required to complete both exams and the 50 hours of continuing education within three years of their application purchase date before needing to re-apply.

“As a direct result of Group Certification, UnityPoint Clinic has seen a great impact on provider engagement and satisfaction. Our practice managers have a deeper knowledge of this complex environment and now have the tools and skills to help our team members, physicians and advanced practitioners navigate this complexity.”

– JESSICA MEISNER
MGMA Member, Vice President,
Human Resources, UnityPoint Health

QUESTIONS?

Email: acmpe@mgma.org

Call: 877.275.6462 Ext. 1888

THANKS to Sponsors & Exhibitors for your support of GKC MGMA!

